

# WELCOME



# FDOT Community Conversations



# TITLE VI

---

## **THIS PUBLIC OPEN HOUSE MEETING IS BEING CONDUCTED IN ACCORDANCE WITH TITLE VI OF THE CIVIL RIGHTS ACT OF 1964**

**Public participation is solicited without regard to race, color, national origin,  
age, sex, religion, disability or family status. Persons wishing to express their  
concerns relative to adherence to Title VI  
may do so by contacting either:**

**Roger Roscoe**

FDOT District Seven  
Title VI Coordinator  
11201 N. McKinley Drive  
Tampa, FL 33612  
813-975-6411  
[Roger.Roscoe@dot.state.fl.us](mailto:Roger.Roscoe@dot.state.fl.us)

**Stefan Kulakowski**

FDOT State  
Title VI Coordinator  
605 Suwannee Street  
Tallahassee, FL 32399  
850-414-4742  
[Stefan.Kulakowski@dot.state.fl.us](mailto:Stefan.Kulakowski@dot.state.fl.us)



**TAMPA BAY**  
**Next**  
THE FUTURE OF  
TRANSPORTATION

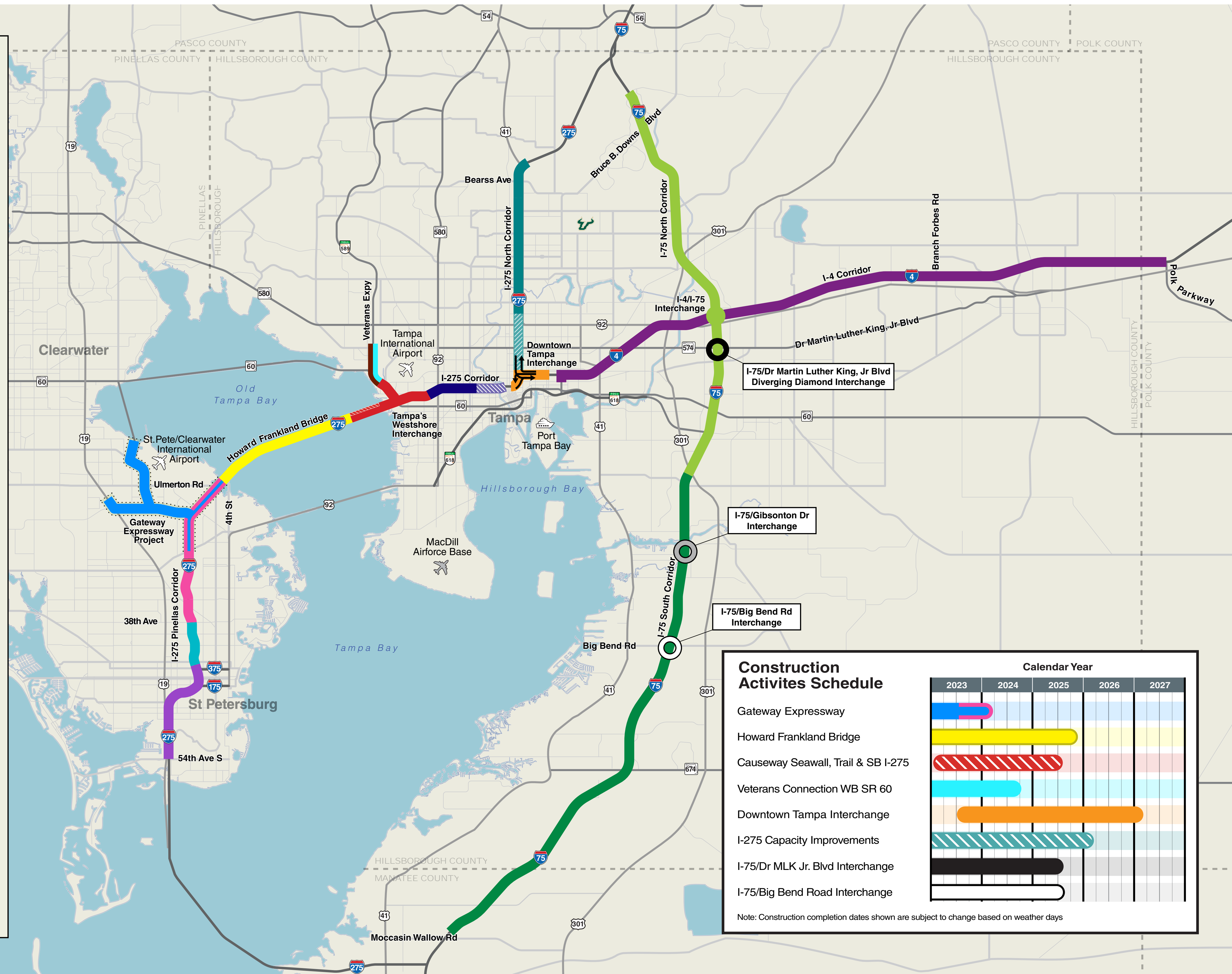



## Safety and Operational Improvements Project

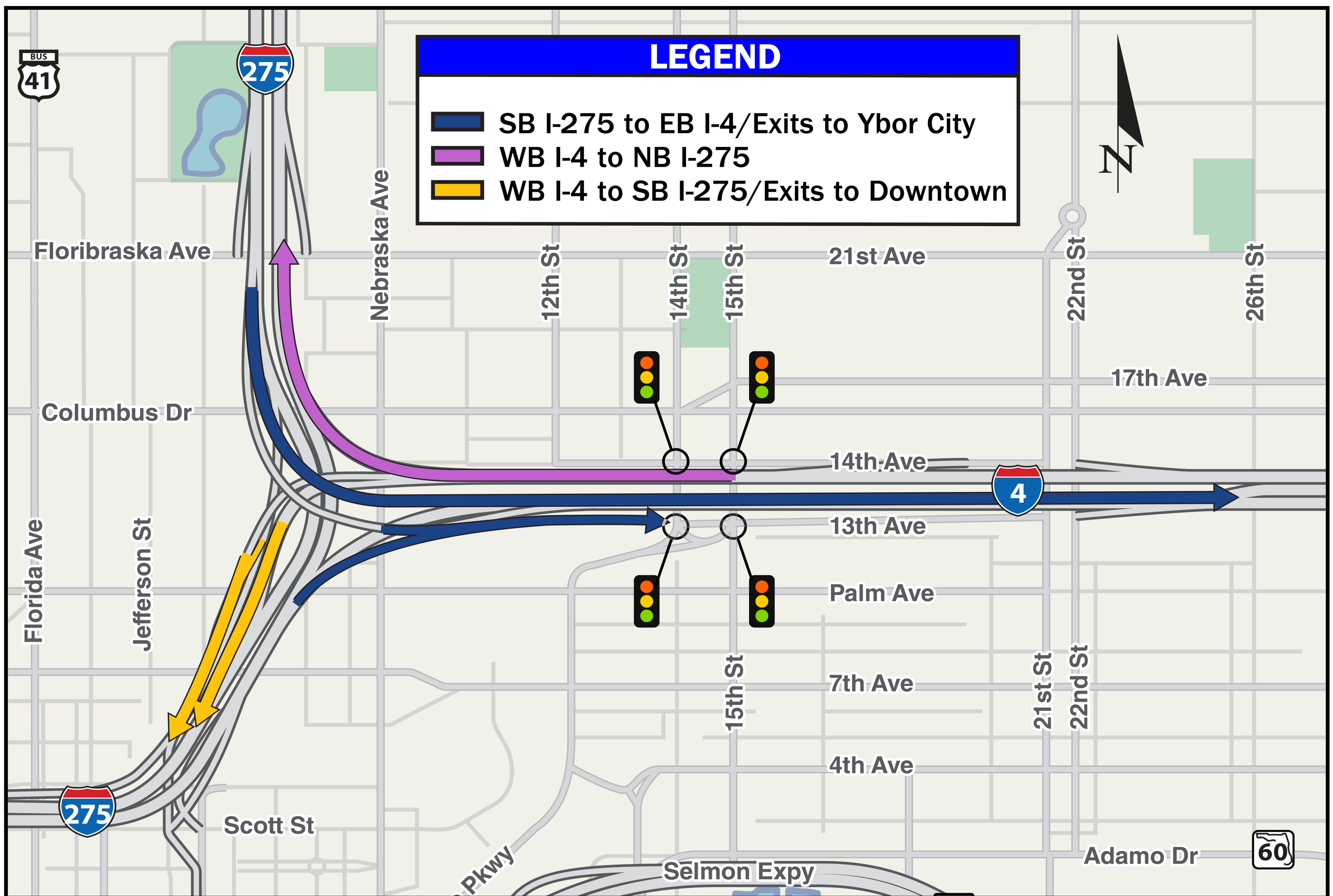

### Southbound I-275 to Eastbound I-4

- Widen the existing single-lane exit ramp from SB I-275 to EB I-4 to two lanes where drivers can either access I-4 via the new two-lane flyover bridge and enter on the left (median) side of the existing roadway, or continue along the existing single-lane flyover bridge to access Ybor City/East Tampa via a relocated exit to 14th/15th Streets
  - The relocated exit to 14th/15th Streets will also be accessible to NB I-275 drivers via a new exit located north of Palm Avenue
- Widen EB I-4 existing frontage road (13th Avenue) to two lanes, which provides access from the relocated exit at 14th/15th Streets to 21st/22nd Streets
- Add a fifth lane (auxiliary) along EB I-4 between I-275 and the Selmon Expressway exit and provide a two-lane exit to the Selmon Expressway

### Westbound I-4 to Northbound I-275

- Widen existing one-lane ramp from I-4 to NB I-275 to two lanes
- Additional merge lane on NB I-275 from the interchange to north of the Dr. Martin Luther King Jr. Boulevard exit

### Westbound I-4 to Southbound I-275

- Widen two-lane ramp from I-4 to SB I-275 to three lanes
- Widen shoulders on SB I-275 from Palm Avenue to Jefferson Street
- Downtown exit ramps shifted to the west



Downtown Tampa Interchange (I-275/I-4) (Section 6)

I-275 Capacity Improvements Projects (Section 7, Phase I, under construction)

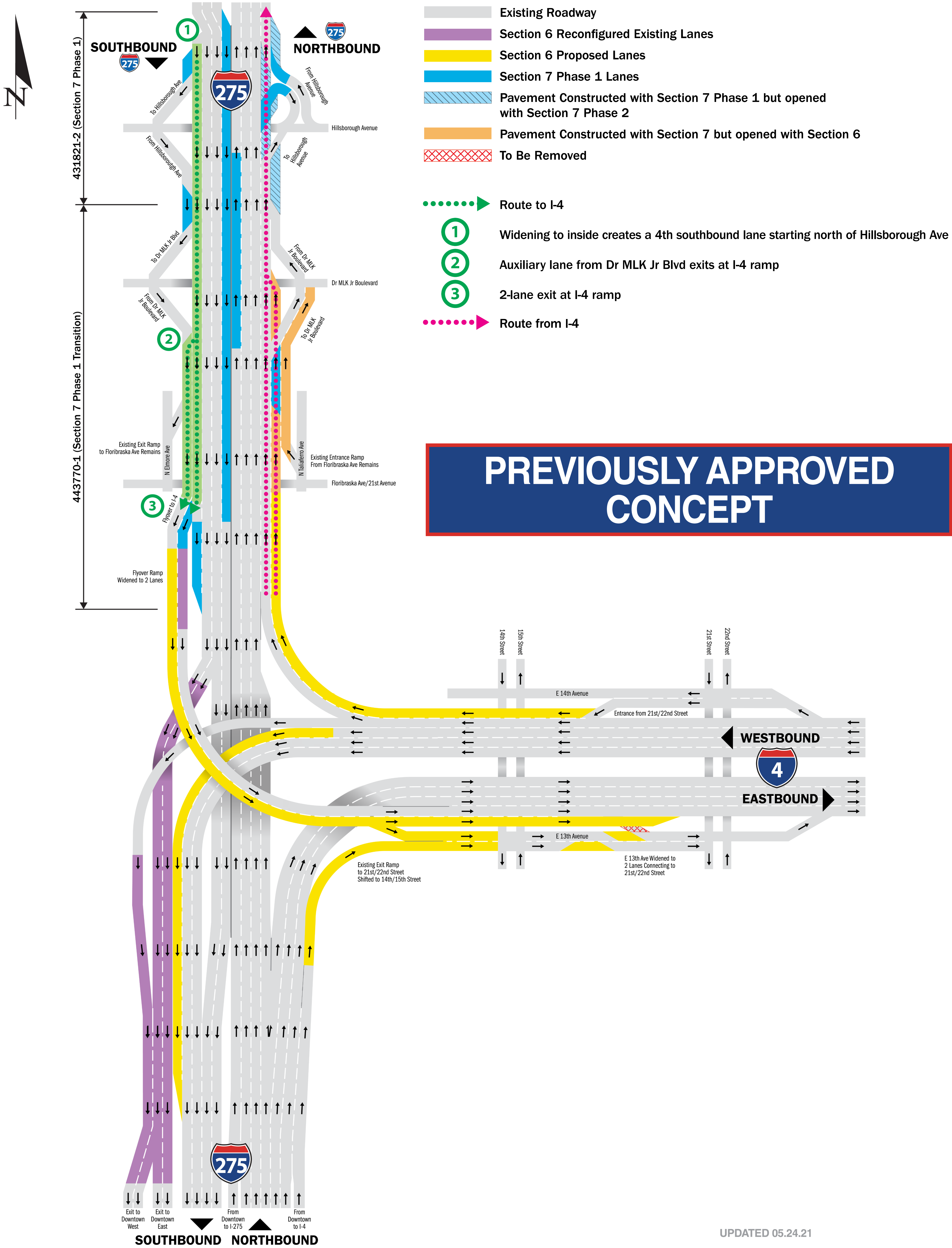



Downtown Tampa Interchange (I-275/I-4) (Section 6)

I-275 Capacity Improvements Projects (Section 7, Phase I, under construction)

