



David Gwynn, P.E.

Secretary, FDOT District 7

March 11 2019



Brightline



Ongoing Public Involvement



COMMUNITY
EVENTS

77



NEWSLETTERS
& EMAIL BLASTS

49

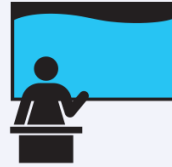

PRESENTATIONS

149



ACTIVE
SUBSCRIBERS

4,417



FDOT PUBLIC
MEETINGS

30



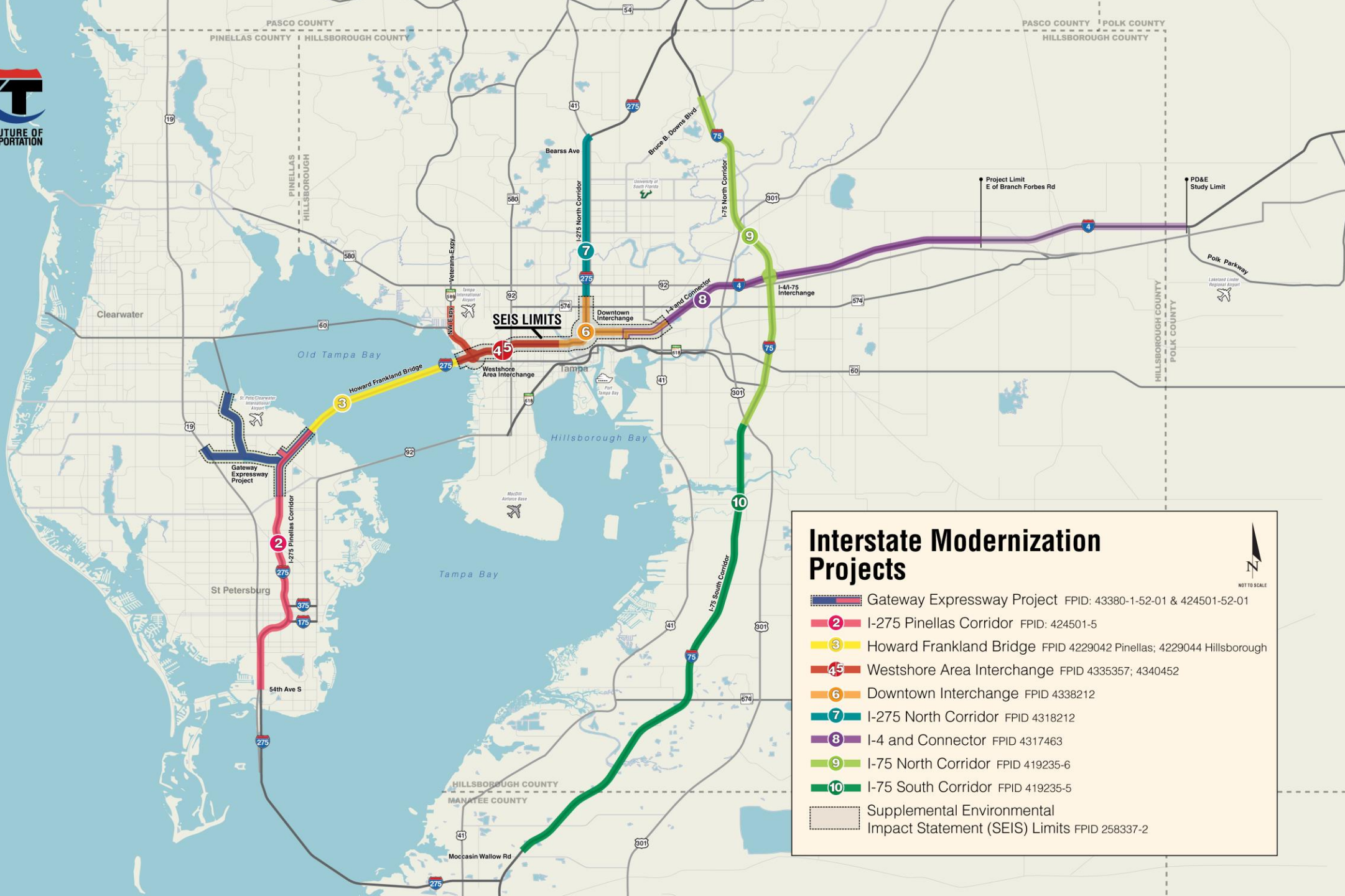

Interstate Modernization Projects

- Gateway Expressway Project FPID: 43380-1-52-01 & 424501-52-01
- I-275 Pinellas Corridor FPID: 424501-5
- Howard Frankland Bridge FPID 4229042 Pinellas; 4229044 Hillsborough
- Westshore Area Interchange FPID 4335357; 4340452
- Downtown Interchange FPID 4338212
- I-275 North Corridor FPID 4318212
- I-4 and Connector FPID 4317463
- I-75 North Corridor FPID 419235-6
- I-75 South Corridor FPID 419235-5
- Supplemental Environmental Impact Statement (SEIS) Limits FPID 258337-2



NOT TO SCALE

Supplement Environmental Impact Statement (SEIS)

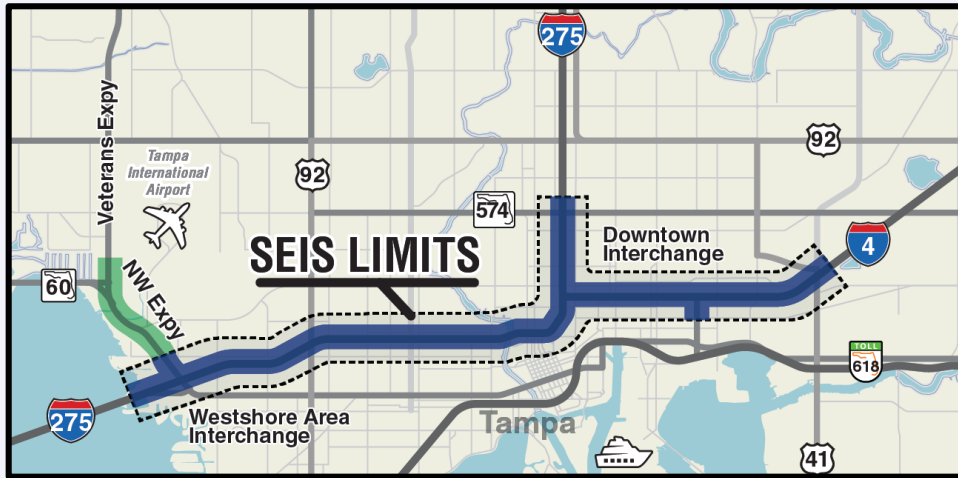

We are here



Draft documents will be available at the spring Public Workshop and will remain open for public comment until after the Public Hearing in 2020.

SEIS Began
January 2017

Public Workshop
October 2017

Preparation of
Documents
Ongoing

Public Workshop
Spring 2019

Public Hearing
Early 2020

*Typically, a Preferred Alternative would be recommended after the Spring 2019 Public Workshop.

Existing Conditions



Proposed Design

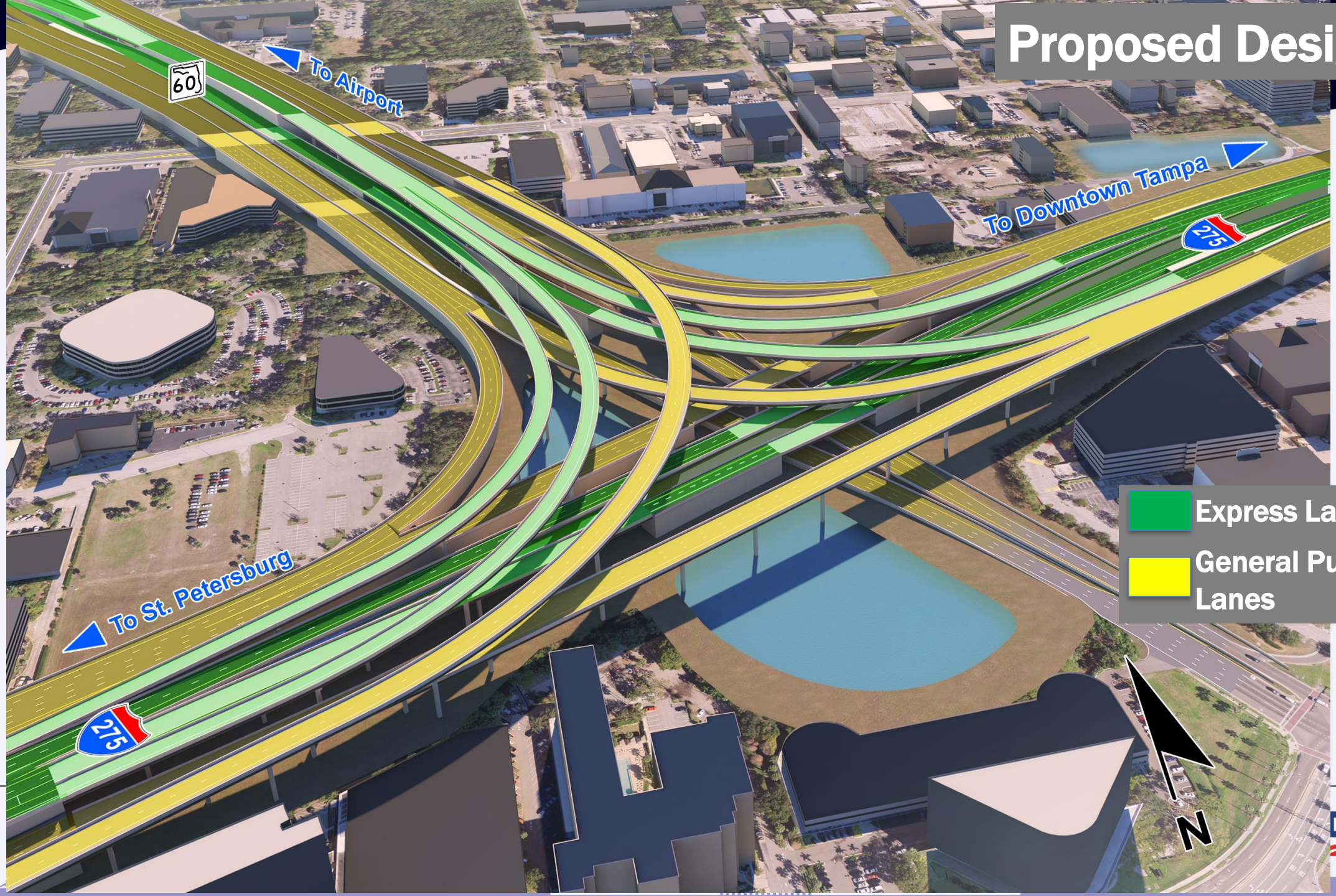

Downtown Interchange

Four Design Options

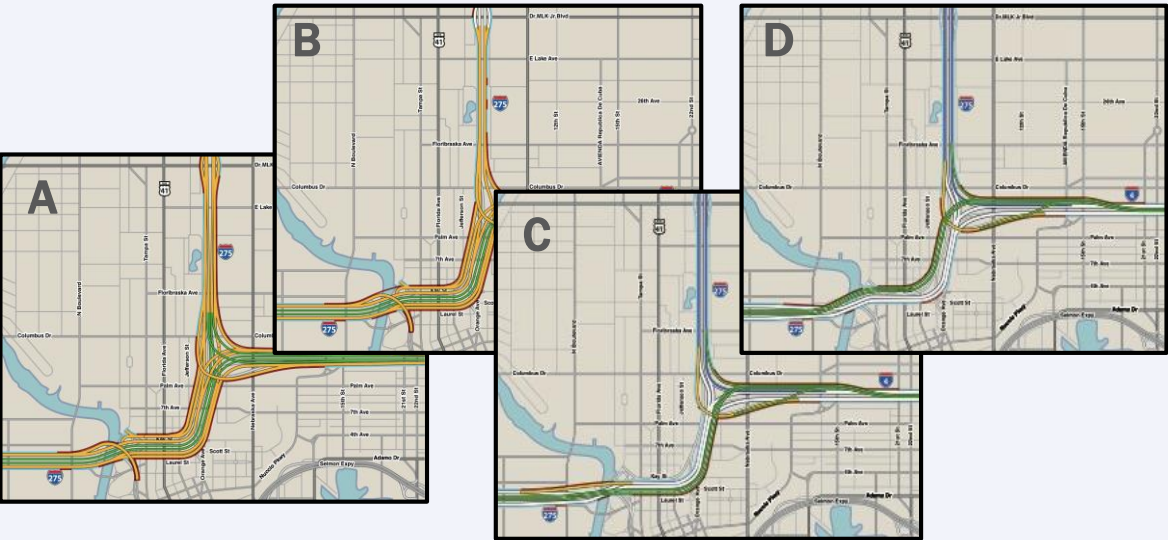

No Further Action



I-275 Corridor

Transition Limits

From I-4 to north of Martin Luther King, Jr. Boulevard
(WPI 443770-1)

- Project limits from I-4 to north of Martin Luther King, Jr. Boulevard
- Approximately 1.57 miles
- Provides auxiliary lane(s) in each direction from I-4 ramp to Martin Luther King, Jr. Boulevard
- No R/W acquisition

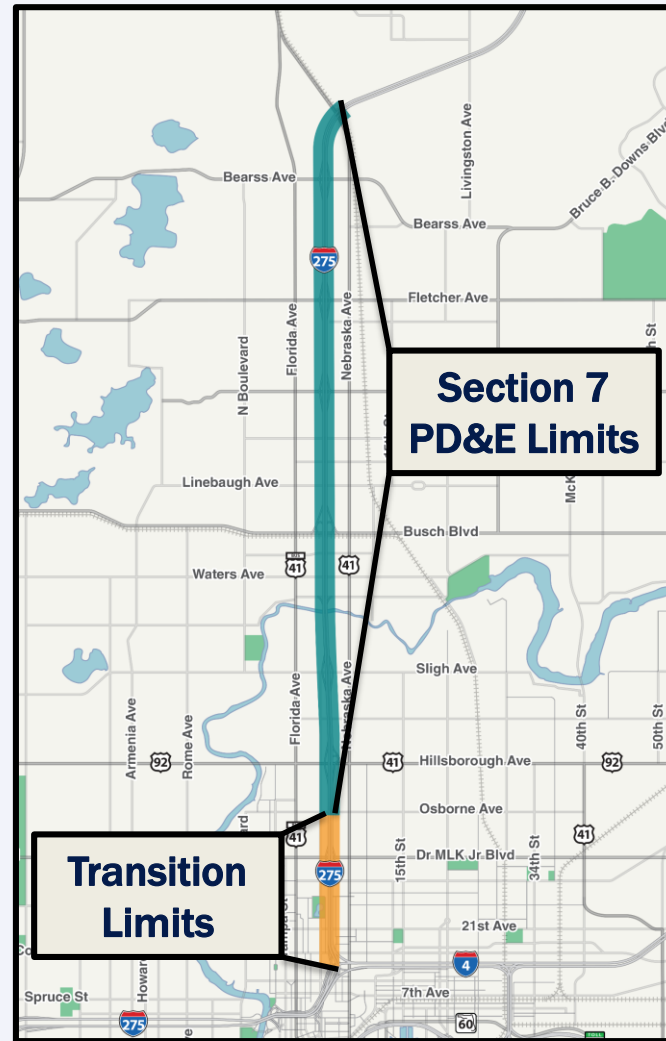

Section 7 PD&E Limits

From north of Martin Luther King, Jr.,
Boulevard to north of Bearss Avenue
(WPI 431821-1)

- Project limits are from north of Dr. Martin Luther King, Jr. Boulevard (SR 574) to north of Bearss Avenue (SR 678/CR 582)
- Approximately 7.70 miles
- Only R/W acquisition anticipated is at Bearss Ave interchange for storm water ponds



Transition

From I-4 to north of Martin Luther King, Jr. Boulevard

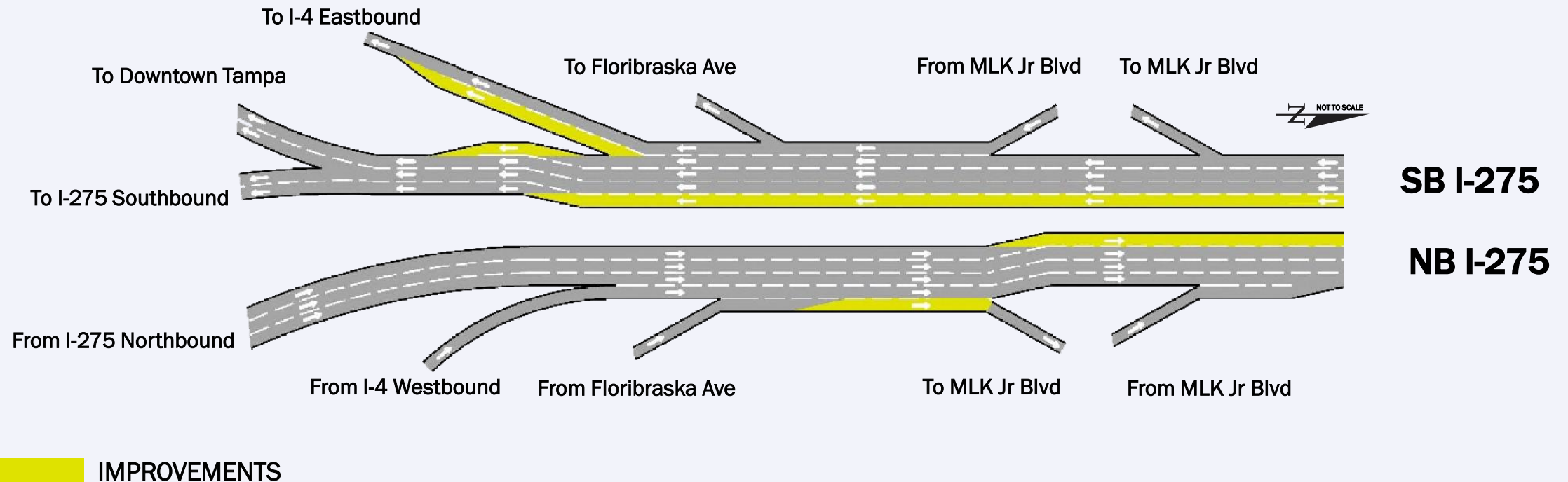

I-275 Corridor

Preferred Typical Section

(4-general use lanes with full depth pavement on inside shoulders)

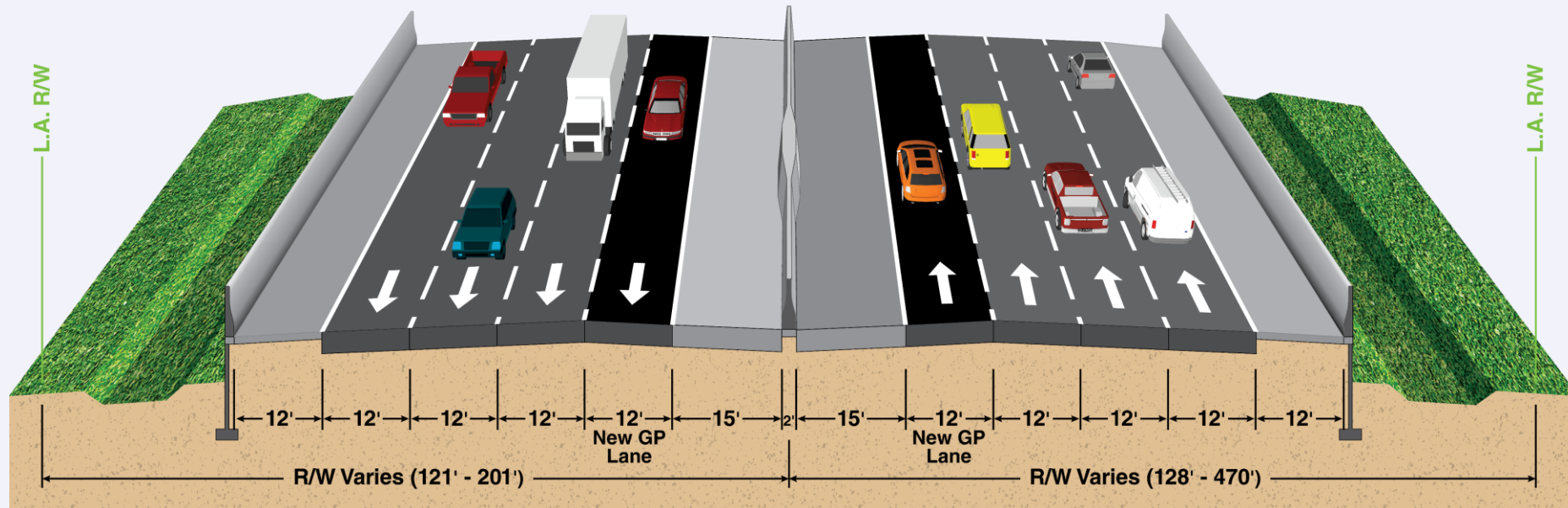

Pedestrian Friendly Underpass Improvements

- Widen Sidewalks
- Enhance Lighting
- Paint Bridge Sub-Structure
- Cut-back Walls for Improved Bike/Pedestrian Experience
- Include Public Art (in cooperation with City of Tampa)
- Identify Landscape Opportunities

Listed improvements are yet finalized for each underpass. All improvements will not be included at every underpass.

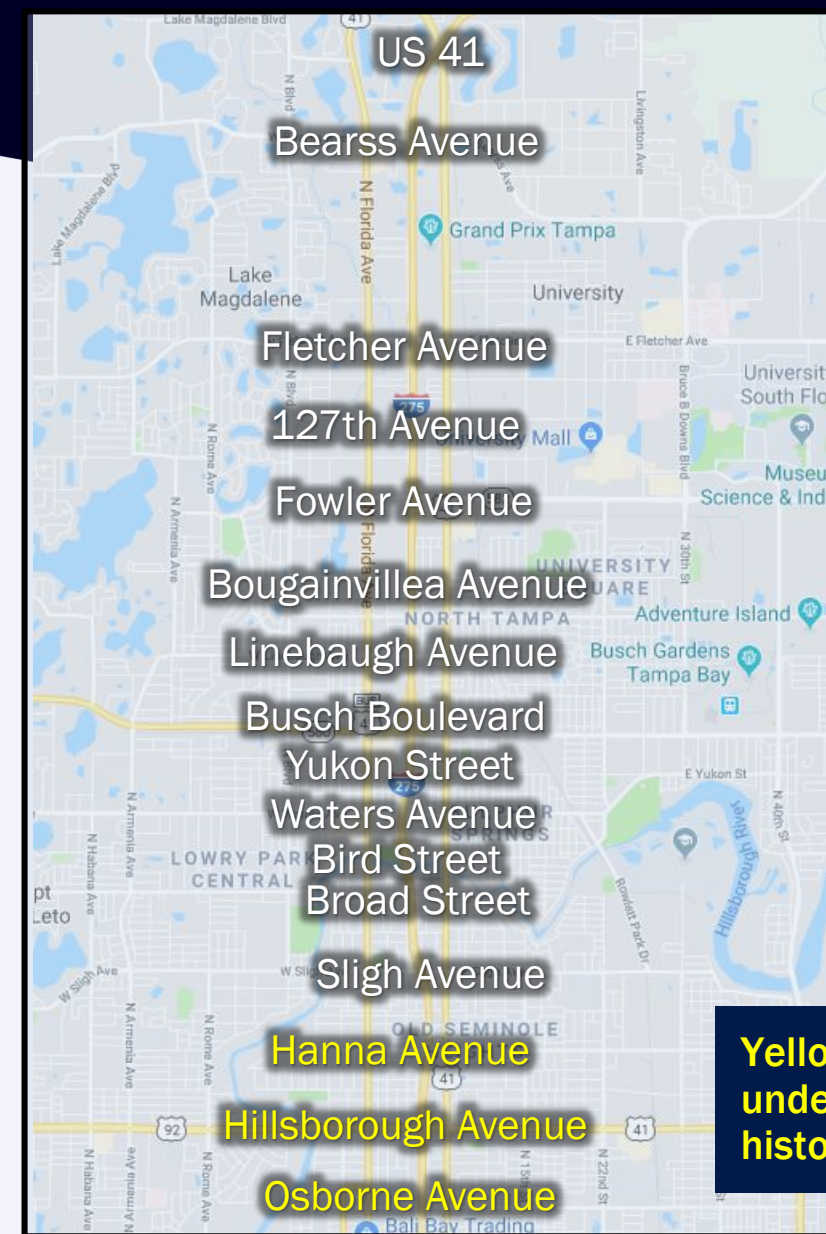

Yellow text indicates underpass is within a historic district.

Underpass Improvements

4- Lane Example



Before



After

Underpass Improvements

6-Lane Example



Before



After

Attractive Sound Walls*

- Aesthetically Attractive
- Early construction to mitigate traffic and construction noise, where possible
- Future coordination with affected property owners and local government to take place during the next project phase



Landscape Opportunities

- FDOT Right of Way along Sound Walls
- Adjacent to Underpasses
- Coordination and Input from City of Tampa Parks



I-275 North Corridor Public Hearing

**Tuesday, March 26, 2019
5:30 p.m. to 7:30 p.m.**

**Seminole Heights
United Methodist Church
6111 N. Central Avenue
Tampa, Florida 33604**





Thank You